

CORTE A-A
escala 1:50

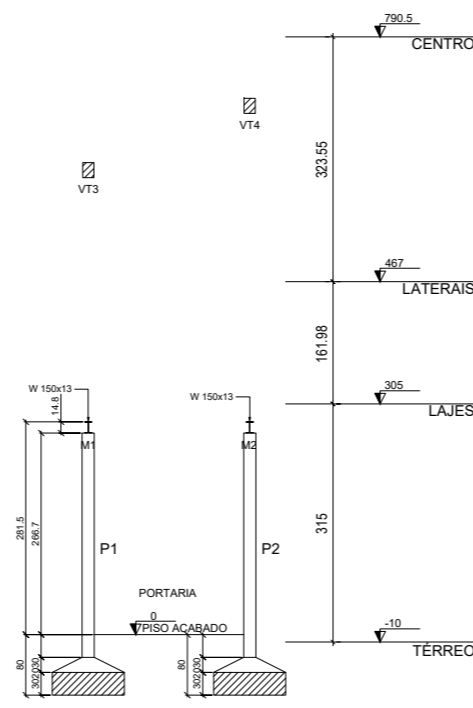

CORTE B-B
escala 1:50

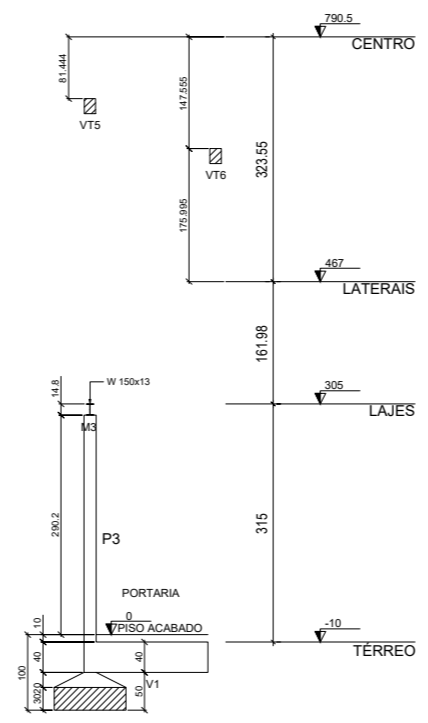

CORTE C-C
escala 1:50

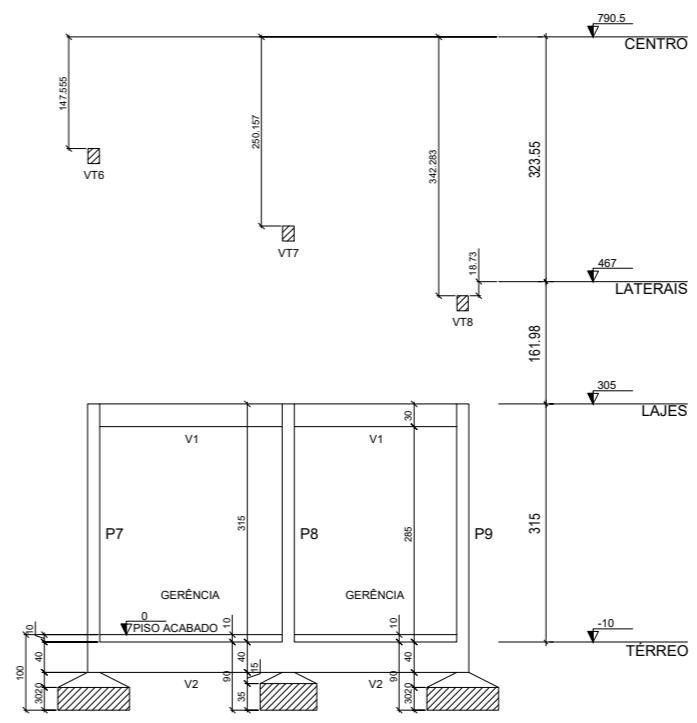

CORTE D-D
escala 1:50

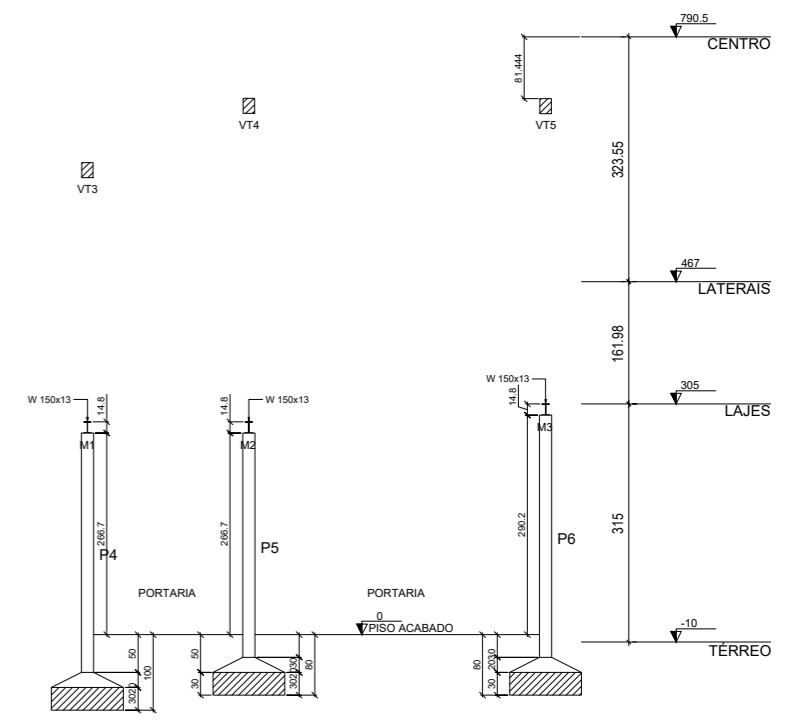

CORTE E-E
escala 1:50

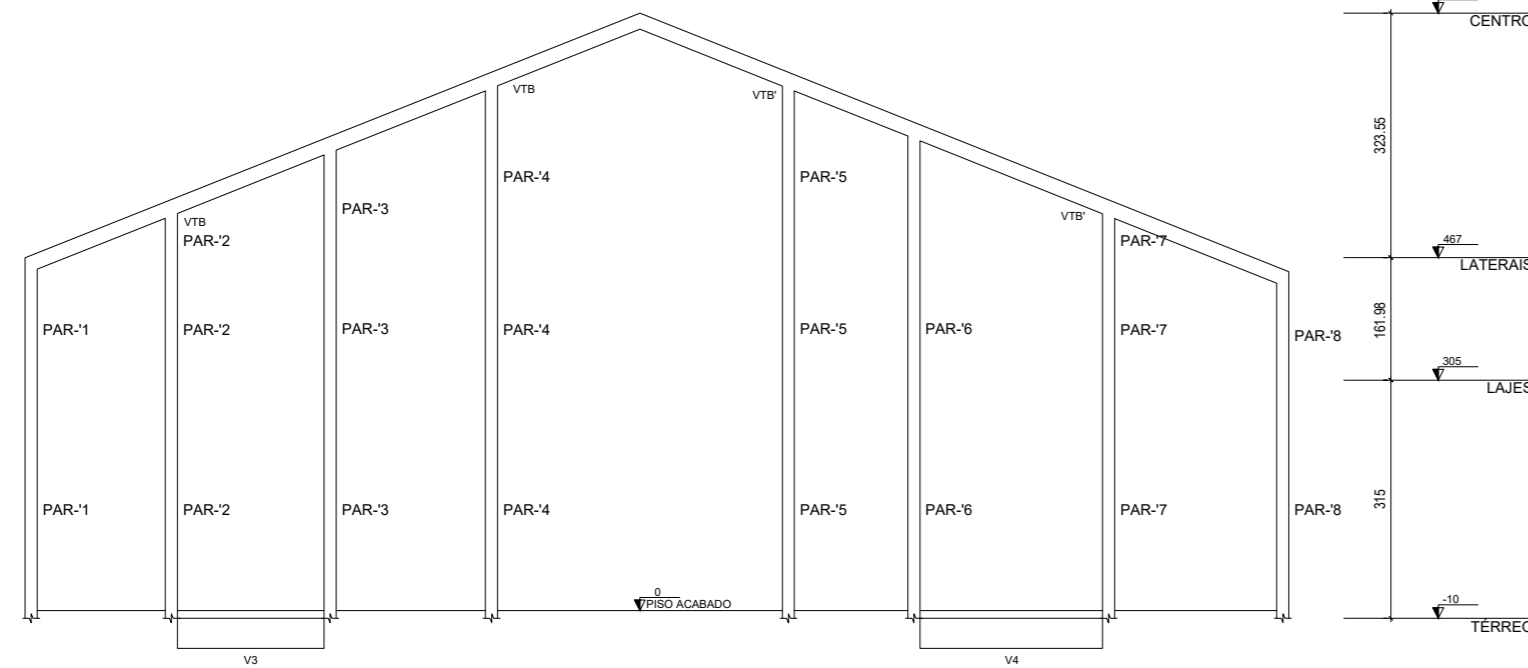

CORTE F-F
escala 1:50

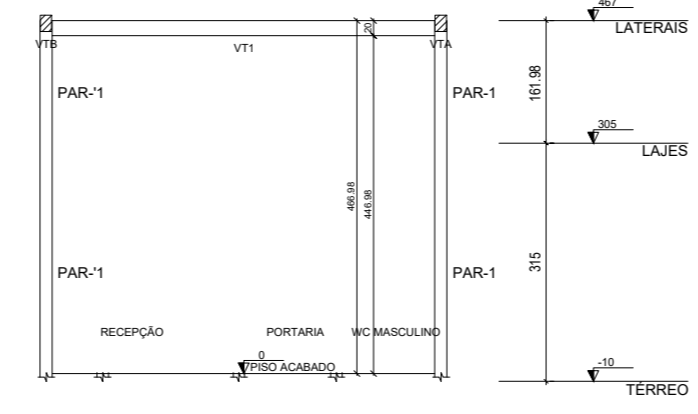

CORTE G-G
escala 1:50

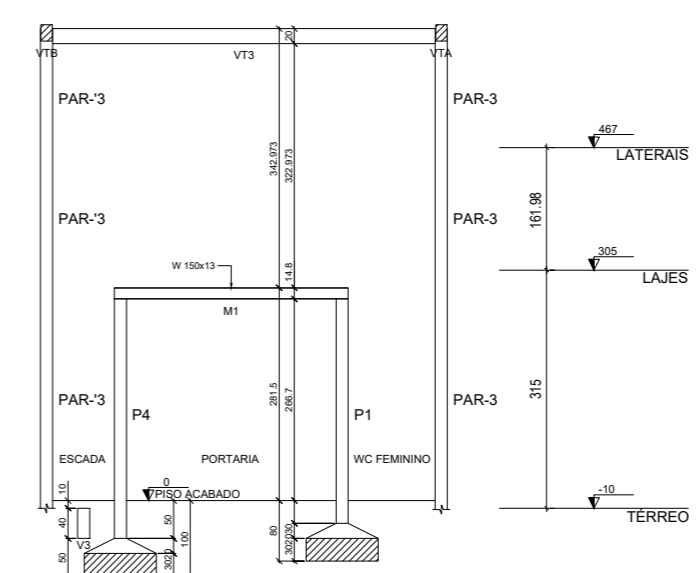

CORTE H-H
escala 1:50

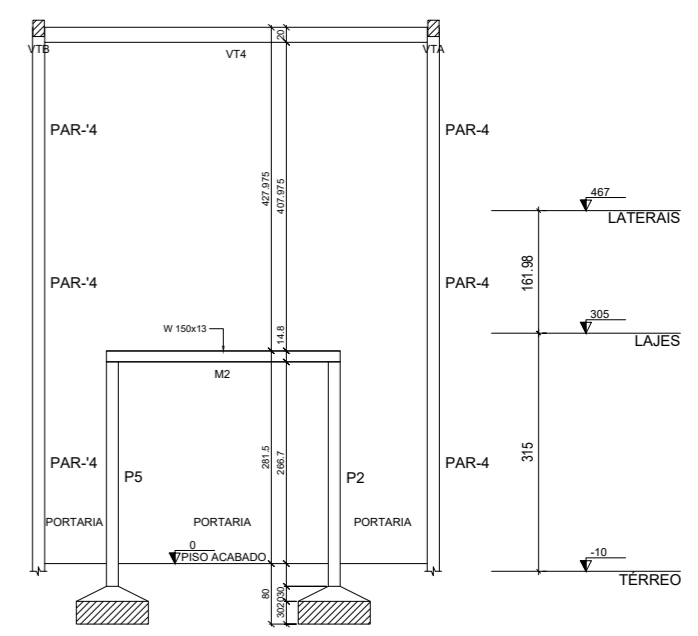

CORTE I-I
escala 1:50

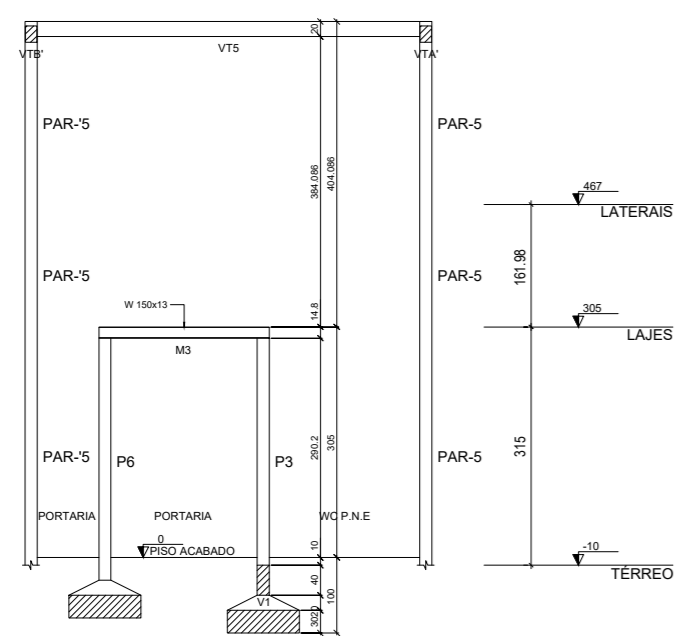

CORTE J-J
escala 1:50

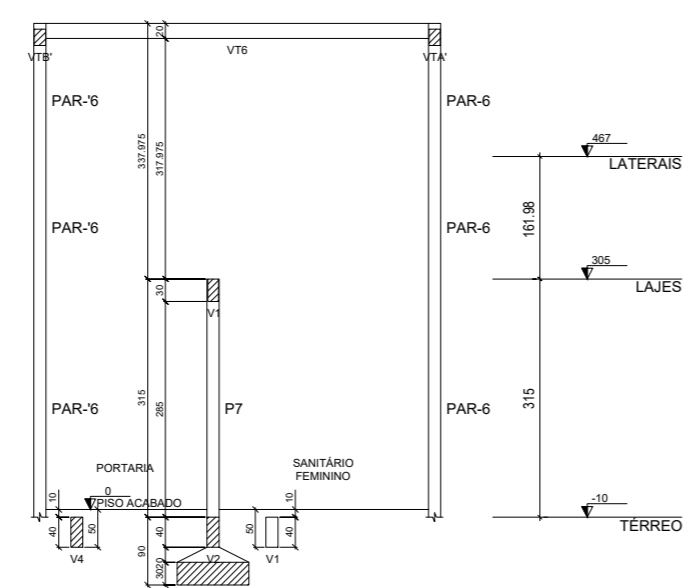

CORTE K-K
escala 1:50

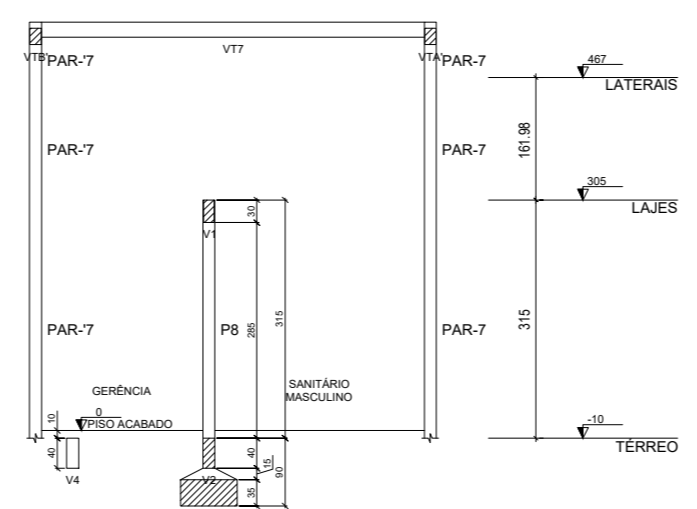

CORTE L-L
escala 1:50

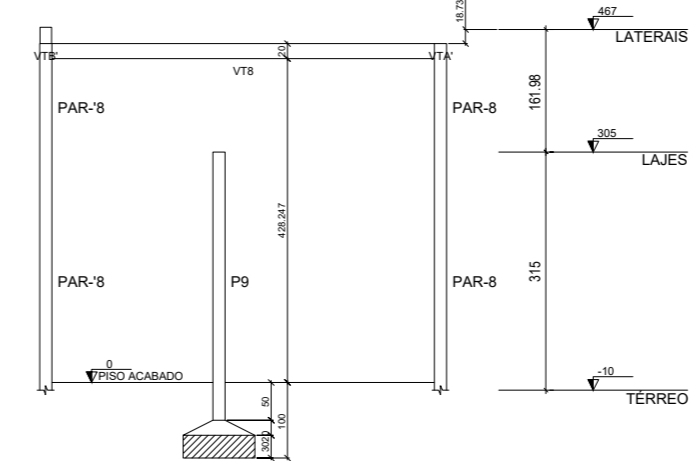

CORTE M-M
escala 1:50

| | | |
|-----------------------------------|---|---------------------------------------|
| PROJETO | PROJETO | PROJETO |
| <input type="checkbox"/> LIBERADO | <input type="checkbox"/> LIBERADO COM RESTRIÇÃO | <input type="checkbox"/> NÃO LIBERADO |
| RESPONSÁVEL TÉCNICO | | |
| 0 | EMISSÃO INICIAL | A.C. ABR/2024 |
| 1 | REVISÃO | RESPONSÁVEL DATA |

- NOTAS**
1. CONFERIR MEDIDAS NO LOCAL
 2. MEDIDAS EM METRO, EXCETO ONDE INDICADO
 - 3.
 - 4.
 - 5.
 - 6.
 - 7.
 - 8.
 - 9.
 - 10.
 - 11.

GOVERNO DO ESTADO DE SÃO PAULO
Secretaria de Estado da Saúde

HOSPITAL GUILHERME ÁLVARO
RUA OSWALDO CRUZ, 197 - BOQUEIRÃO - SANTOS/SP

GRUPO TÉCNICO DE EDIFICAÇÕES

PROJETO ESTRUTURA METÁLICA

H-041 FL.02/03

17/00 ABRIL/2024

PROJETO HOSPITAL GUILHERME ÁLVARO.DWG

Eng. GLAÚDIO LUIS BRAGA
Arg. CAMILO CHINGOTTE